

CONCEPT DESIGN

SIDEWALK IMPROVEMENTS ALONG KENTLAND AVE., HOPEWELL AVE., AND LARCH AVE.

APRIL 2022

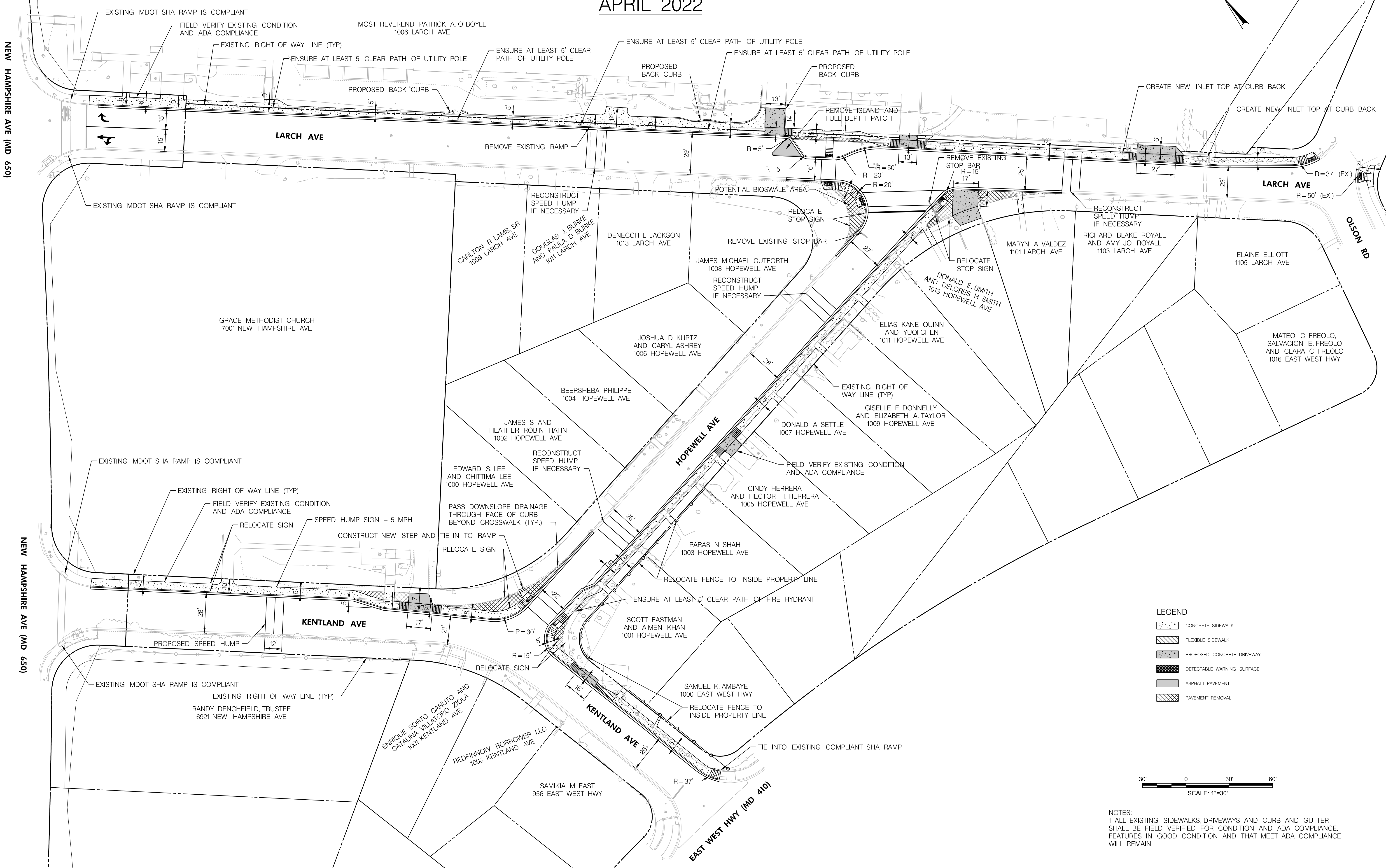
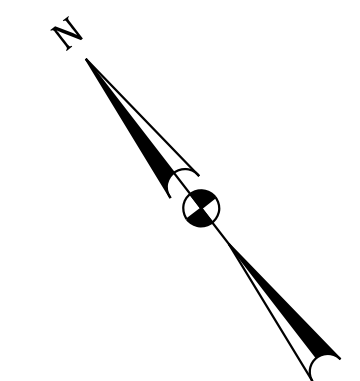

LEGEND

	CONCRETE SIDEWALK
	FLEXIBLE SIDEWALK
	PROPOSED CONCRETE DRIVEWAY
	DETECTABLE WARNING SURFACE
	ASPHALT PAVEMENT
	PAVEMENT REMOVAL

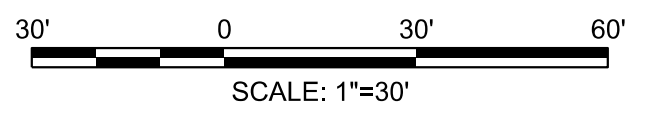

NOTES:
1. ALL EXISTING SIDEWALKS, DRIVEWAYS AND CURB AND GUTTER SHALL BE FIELD VERIFIED FOR CONDITION AND ADA COMPLIANCE. FEATURES IN GOOD CONDITION AND THAT MEET ADA COMPLIANCE WILL REMAIN.