

- NOTES:**
1. REMOVE EXISTING INLET AND 5 L.F. OF PIPE. INSTALL CURB OPENING INLET TO MAINTAIN EXISTING DRAINAGE PATTERNS.
 2. REDUCTION OF ROADWAY WIDTH (22' CURB TO CURB) REQUIRES ELIMINATING PARKING ON ONE SIDE OF THE STREET TO MAINTAIN 2-WAY TRAFFIC.
 3. MODIFY EXISTING STORM WATER FACILITY AREA TO ACCOMMODATE PROPOSED SIDEWALK.
 4. INSTALL OPEN BACK COG TO SPAN PROPOSED SIDEWALK TO MAINTAIN EXISTING DRAINAGE PATTERNS.

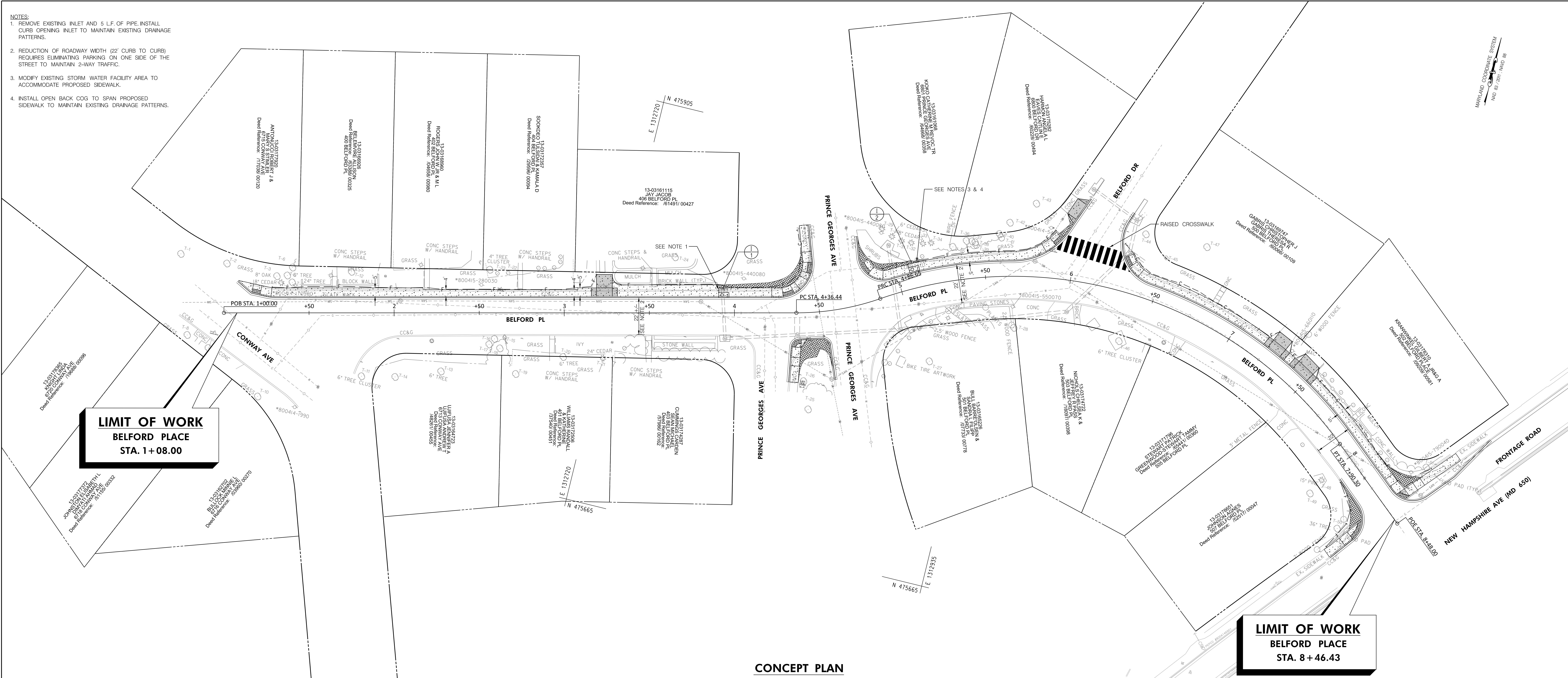
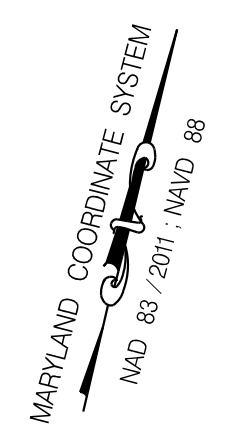

LIMIT OF WORK
BELFORD PLACE
STA. 1+08.00

LIMIT OF WORK
BELFORD PLACE
STA. 8+46.43

CONCEPT PLAN

LEGEND

	PROPOSED CONCRETE DRIVEWAY APRON
	PROPOSED CONCRETE SIDEWALK
	DETECTABLE WARNING SURFACE
	EXISTING PAVEMENT REMOVAL
	TREE TO BE REMOVED
	TREE NUMBER
	CRITICAL ROOT ZONE

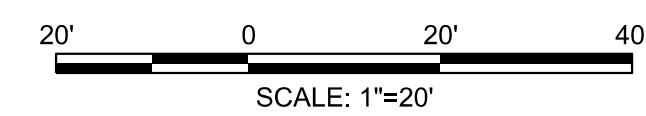

RK&K
 P: 410.728.2900 F: 410.728.2834
 700 East Pratt Street, Suite 500 | Baltimore, MD 21202
 www.rk.com
 Engineers | Construction Managers | Planners | Scientists
 Responsive People | Creative Solutions

DESIGN BY: TMB
 DRAWN BY: TMB
 CHECK BY: RJG

DEPARTMENT OF PUBLIC WORKS
CITY OF TAKOMA PARK
 31 OSWEGO AVENUE
 TAKOMA PARK, MD 20910

ROADWAY PLAN	HD-01
BELFORD PLACE	
SIDEWALK IMPROVEMENTS	
CONWAY AVENUE TO NEW HAMPSHIRE AVENUE	
DATE: <u>MAY 2023</u>	CONTRACT NO. _____
SCALE: <u>1" = 20'</u>	SHEET <u>1</u> OF <u>1</u>

I:\projects\2023\Projects\2023\06\TakomaPark\Task 7 Belford Place\CDM\Plan\p01-0001_Belford.dgn
 5/24/2023