

# CONCEPT DESIGN

## SIDEWALK IMPROVEMENTS ALONG KENTLAND AVE., HOPEWELL AVE., AND LARCH AVE.

### JULY 2022

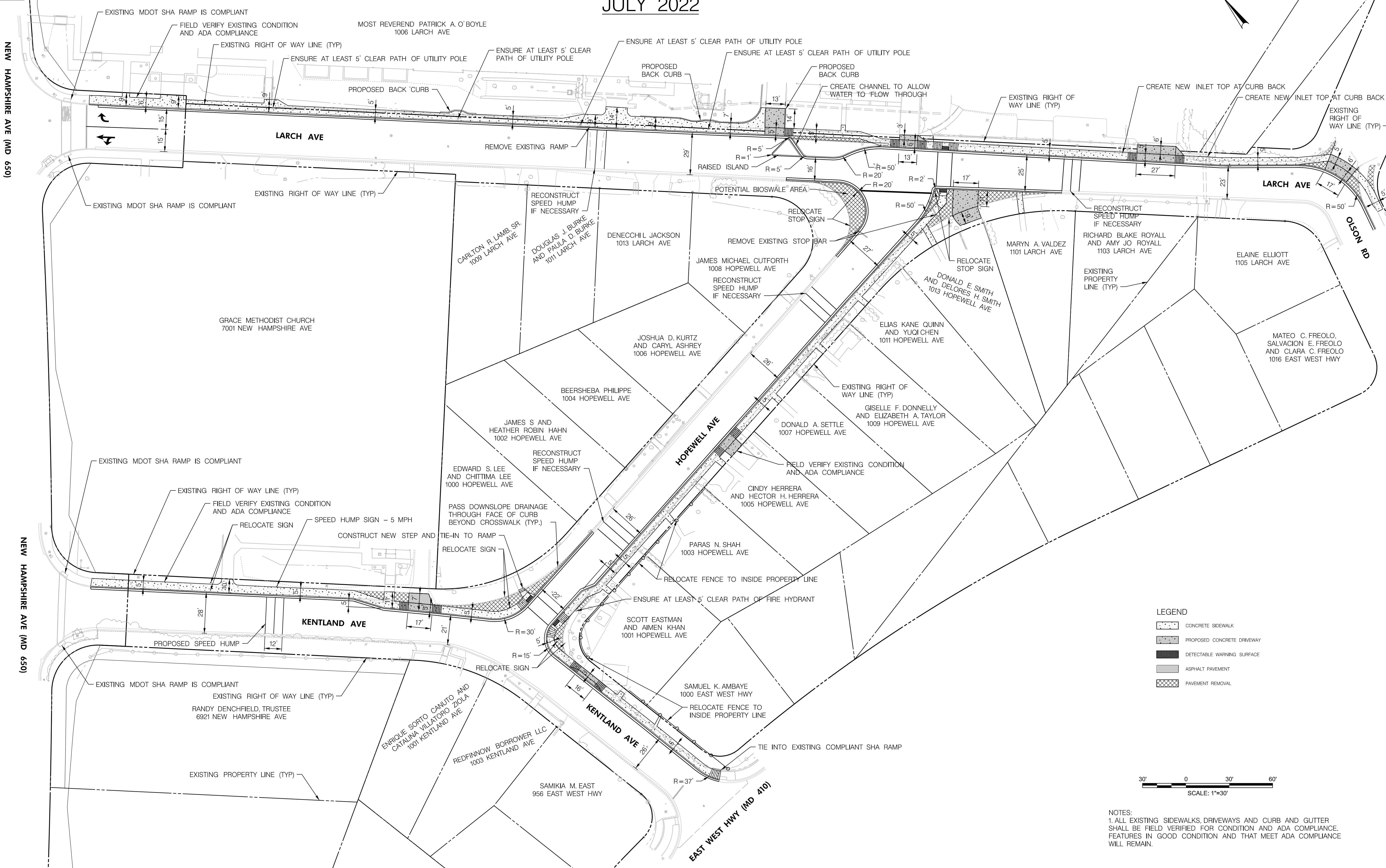
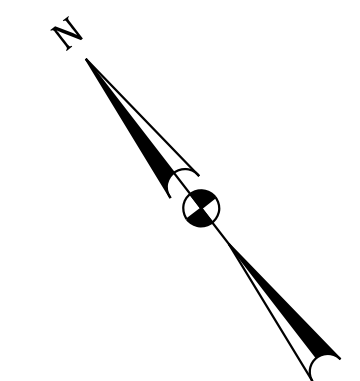

**LEGEND**

	CONCRETE SIDEWALK
	PROPOSED CONCRETE DRIVEWAY
	DETECTABLE WARNING SURFACE
	ASPHALT PAVEMENT
	PAVEMENT REMOVAL

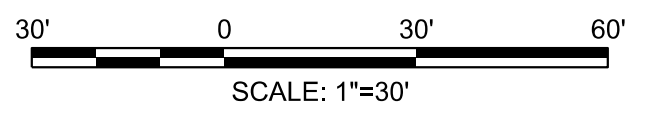

**NOTES:**  
 1. ALL EXISTING SIDEWALKS, DRIVEWAYS AND CURB AND GUTTER SHALL BE FIELD VERIFIED FOR CONDITION AND ADA COMPLIANCE. FEATURES IN GOOD CONDITION AND THAT MEET ADA COMPLIANCE WILL REMAIN.