

- NOTES:**
1. OPEN BACK COG INLET(S) TO SPAN PROPOSED SIDEWALK OR INLET RELOCATION CAN BE UTILIZED TO MAINTAIN EXISTING DRAINAGE PATTERNS.
 2. THERE IS NO EXISTING OR PROPOSED SIDEWALK CONNECTION ALONG CONWAY AVENUE; THEREFORE, NO PEDESTRIAN RAMP IS PROVIDED.
 3. REDUCTION OF ROADWAY WIDTH (22' CURB TO CURB) REQUIRES ELIMINATING PARKING ON ONE SIDE OF THE STREET TO MAINTAIN 2-WAY TRAFFIC.
 4. MODIFY EXISTING MICRO-BIORETENTION AREA TO ACCOMMODATE PROPOSED SIDEWALK.

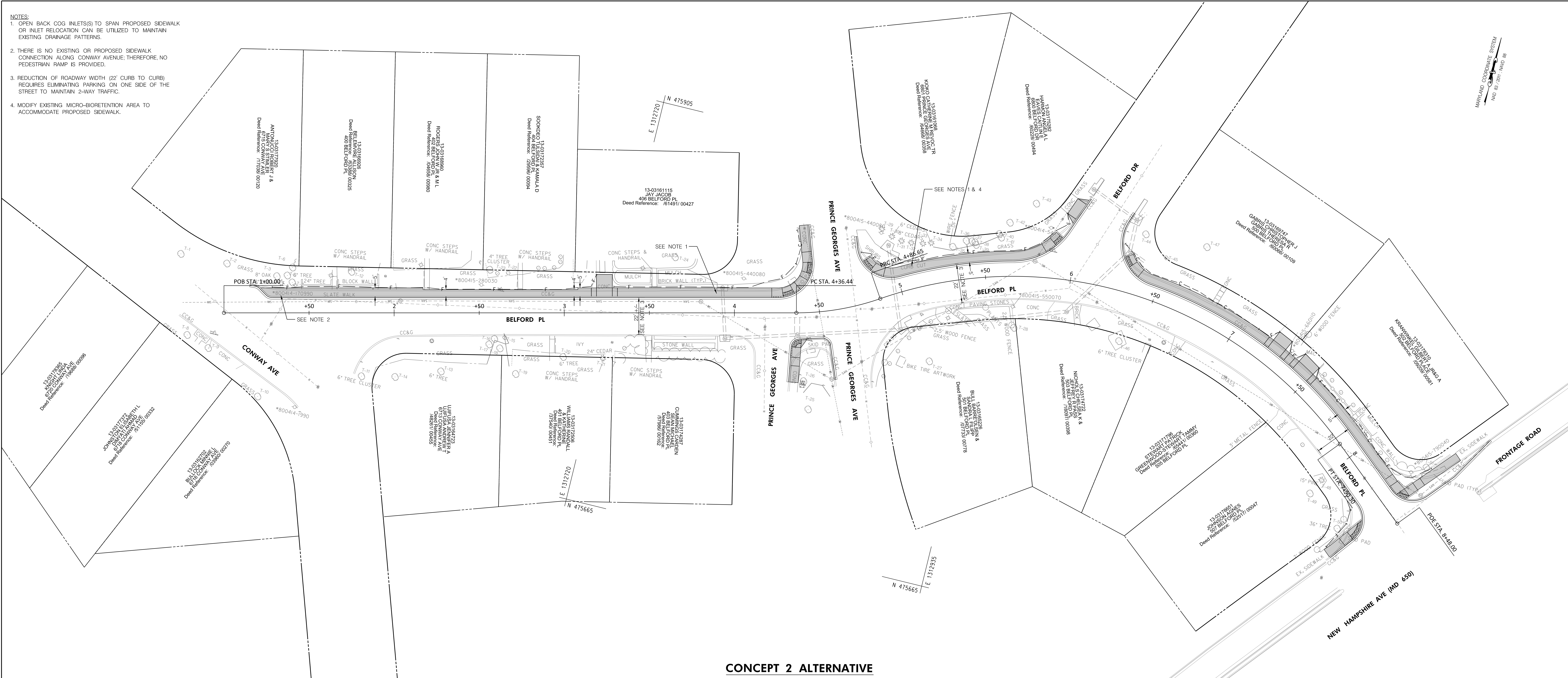
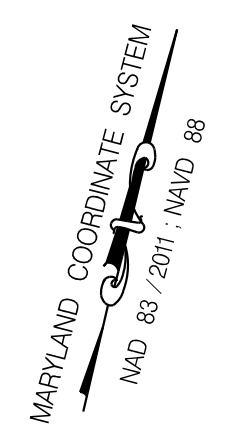

CONCEPT 2 ALTERNATIVE

LEGEND

	EXISTING PAVEMENT REMOVAL
	PROPOSED CONCRETE SIDEWALK
	TREE TO BE REMOVED
	EXISTING TREE & TREE NUMBER
	CRITICAL ROOT ZONE

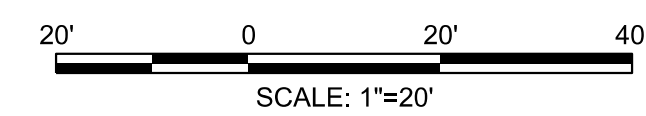

RK&K
Rummel, Klepper & Kahl, LLP
 700 EAST PRATT STREET | BALTIMORE, MD 21202
 SUITE 500 PH: (410) 728-2900
 Engineers | Construction Managers | Planners | Scientists
 www.rkk.com

DESIGN BY: TMB
DRAWN BY: TMB
CHECK BY: RJG

DEPARTMENT OF PUBLIC WORKS
CITY OF TAKOMA PARK
 31 OSWEGO AVENUE
 TAKOMA PARK, MD 20910

CONCEPT PLAN ALTERNATIVE 2	HD-02
BELFORD PLACE SIDEWALK IMPROVEMENTS CONWAY AVENUE TO NEW HAMPSHIRE AVENUE	
DATE: NOVEMBER 2022	CONTRACT NO. _____
SCALE: 1" = 20'	SHEET 02 OF 02

I:\projects\2020\2020-06-16-10-00-00\Belford\Drawings\Task 7_Belford_Place\CDM\Plan\pub-0002_Belford.dgn
 11/17/2022