

SIDEWALK IMPROVEMENTS ALONG CHESTNUT AVE., HODGES LANE AND DARWIN AVE.

CONCEPT DESIGN – ALTERNATIVE LAYOUT

AUGUST 2024

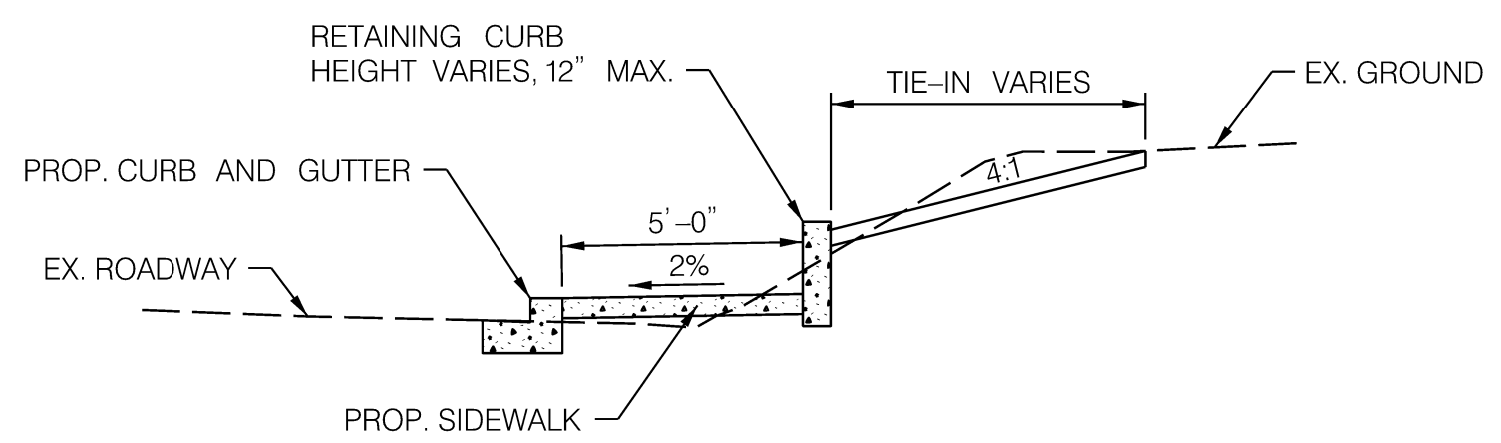
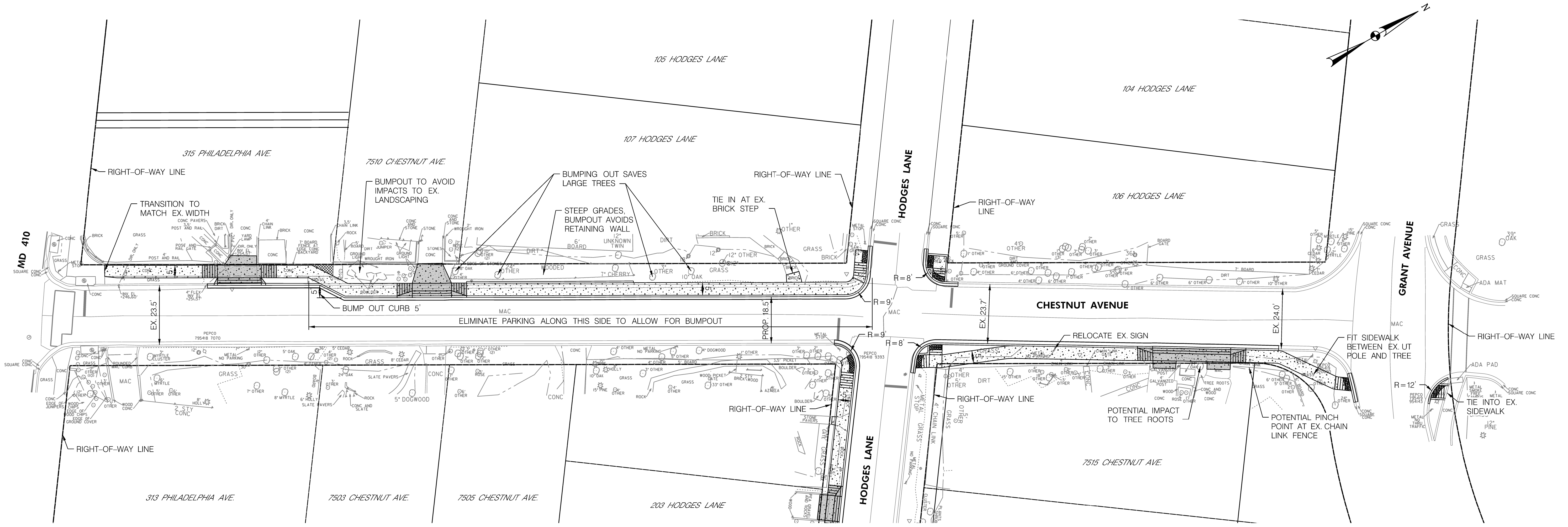

TYPICAL SIDEWALK SECTION WITH BACK CURB
ALONG CHESTNUT AVE.

- CONCRETE DRIVEWAY
- CONCRETE SIDEWALK
- DETECTABLE WARNING SURFACE
- REMOVAL OF EXISTING CONCRETE / ASPHALT

DESIGN NOTES

1. POSSIBLE TREE REMOVALS – 0
2. POSSIBLE TREE ROOT IMPACTS – 1
3. POSSIBLE PINCH POINTS – 0
4. PARKING MAY NEED TO BE ELIMINATED ALONG CHESTNUT AVE. FROM MD 410 TO HODGES LANE TO ACCOMMODATE CURBLINE BUMPOUT.

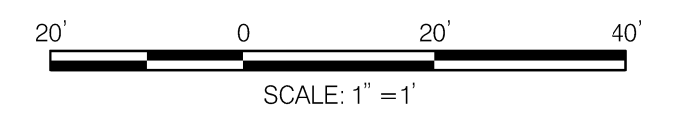

<p>Whitman, Requardt & Associates, LLP 801 South Caroline Street, Baltimore, Maryland 21231</p>	<p>CITY OF TAKOMA PARK</p>
	<p>31 OSWEGO AVENUE SILVER SPRING, MD 20910</p>