

SIDEWALK IMPROVEMENTS ALONG CHESTNUT AVE., HODGES LANE AND DARWIN AVE. CONCEPT DESIGN – PREFERRED LAYOUT AUGUST 2024

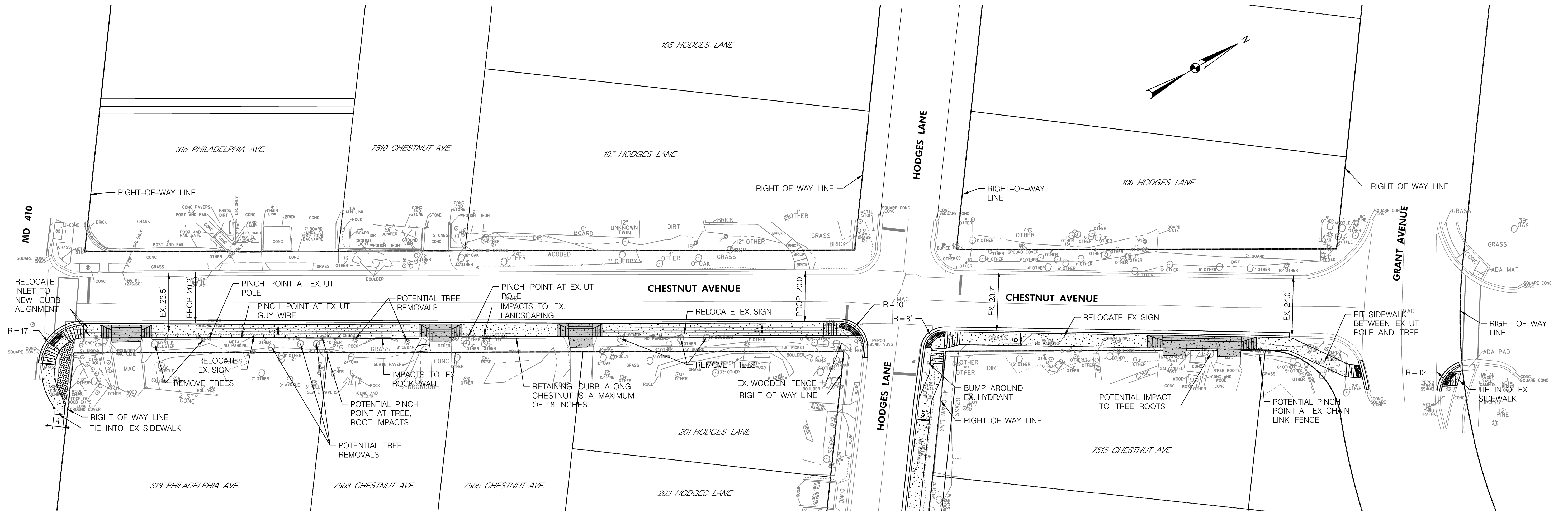

- CONCRETE DRIVEWAY
- CONCRETE SIDEWALK
- DETECTABLE WARNING SURFACE
- REMOVAL OF EXISTING CONCRETE / ASPHALT

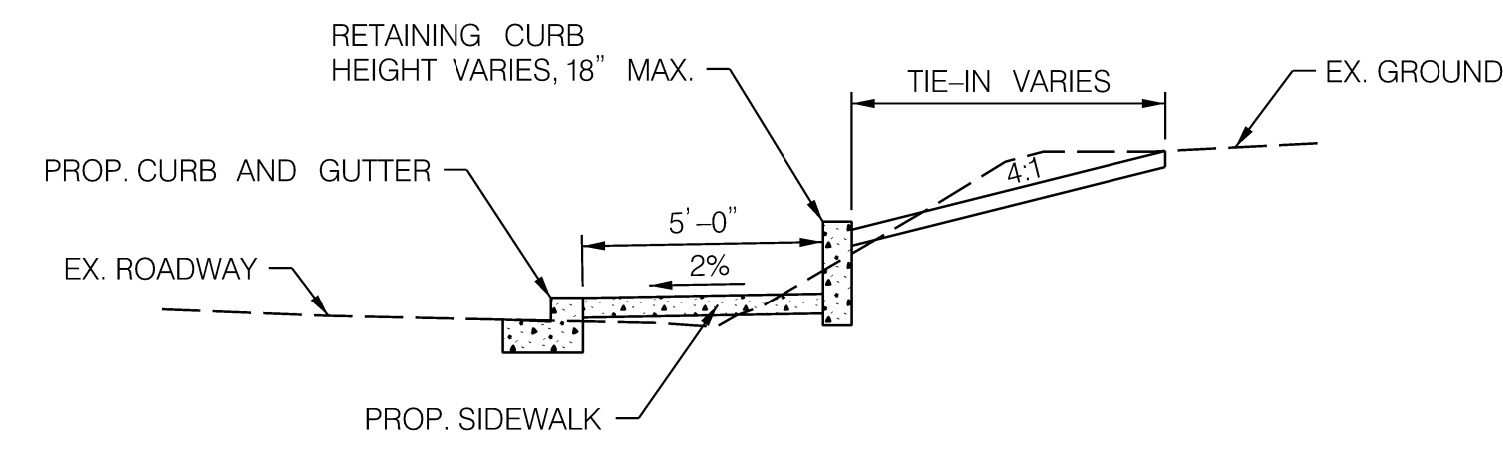

TYPICAL SIDEWALK SECTION
ALONG CHESTNUT AVE.

DESIGN NOTES

1. POSSIBLE TREE REMOVALS – 10
2. POSSIBLE TREE ROOT IMPACTS – 2
3. POSSIBLE PINCH POINTS – 5
4. PARKING MAY NEED TO BE ELIMINATED ALONG CHESTNUT AVE. FROM MD 410 TO HODGES LANE TO ACCOMMODATE CURBLINE BUMP-OUT.

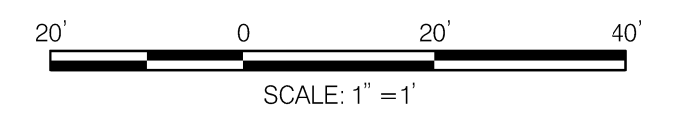

 Whitman, Requardt & Associates, LLP <small>801 South Caroline Street, Baltimore, Maryland 21231</small>	CITY OF TAKOMA PARK
	31 OSWEGO AVENUE SILVER SPRING, MD 20910